



1 FRONT ELEVATION



3 RIGHT ELEVATION

AAC

PZ23-12000017

03/05/2025

COLOR SCHEME KEY

- | | |
|---|--|
| 1 | MAIN
SW 7757
HIGH REFLECTIVE WHITE |
| 2 | TRIMS
SW 7631
CITY LOFT |
| 3 | DETAIL COLOR
SW 7014
EIDER WHITE |
| 4 | SHUTTERS
SW 6766
MARINER |
| 5 | AWNING/BRACKETS
SW 9183
DARK CLOVE |
| 6 | RAILINGS/WINDOWS/
DOOR FRAMES
SW 7048
URBANE BRONZE |
| 7 | ROOFS
BARREL TILES
REDDISH ORANGE |
| 8 | STONE VENEER
FRENCH LIMESTONE CREAM |

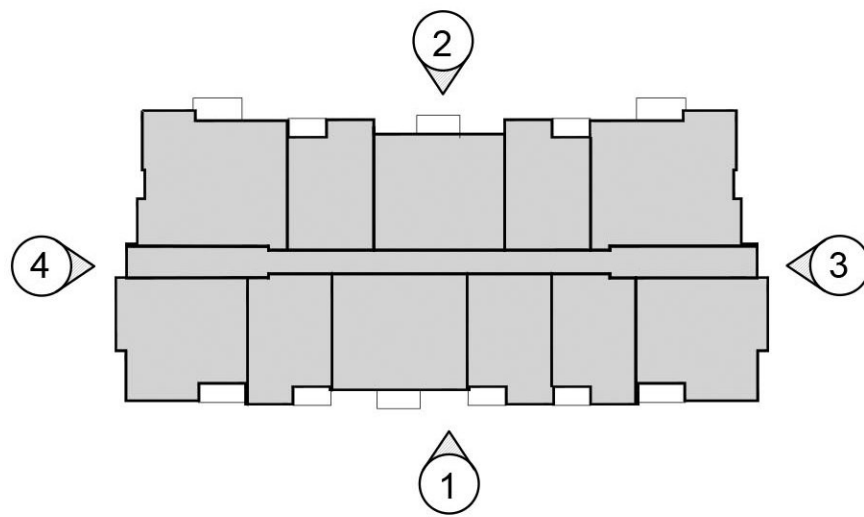

KEYPLAN

N.T.S.
BLDG 1A ELEVATIONS

SCALE: 1/8"=1'-0"

PRE-APP MEETING 04/04/2023	BY
DRC SUBMITTAL 06/13/2023	
DRC RE-SUBMITTAL 08/16/2023	
DRC RE-SUBMITTAL 01/01/2024	
DRC RE-SUBMITTAL 10/16/2024	
DRC RE-SUBMITTAL 12/10/2024	
DRC RE-SUBMITTAL 01/29/2025	

OAKS @ PALM AIRE
FOR:
MORGUARD
LOCATED AT:
POMPANO BEACH, FLORIDA

JOSE L. SAUMWELL
AR0013085

MSA ARCHITECTS, INC.
AAC0000895
8850 SW 74th COURT
SUITE 813
MIAMI, FLORIDA 33156
(305) 273-9911

MSA ARCHITECTS
ARCHITECTURE & PLANNING

ARCHITECT'S BUILDING CODE STATEMENT/ TO THE BEST OF THE ARCHITECT'S KNOWLEDGE THE PLANS AND SPECIFICATIONS COMPLY WITH THE FLORIDA BUILDING CODE SEVENTH EDITION (2020) AND THE APPLICABLE FIRE SAFETY STANDARDS AS DETERMINED BY THE LOCAL AUTHORITY AND CHAPTER 633 FLORIDA STATUTES.
COPYRIGHT © 2022 MSA ARCHITECTS, INC. THE ARCHITECTURAL DESIGN AND DETAIL DRAWINGS FOR THIS BUILDING AND/OR OVERALL PROJECT ARE THE LEGAL PROPERTY OF AND ALL RIGHTS ARE RESERVED BY THE ARCHITECT.
THEIR USE FOR REPRODUCTION, CONSTRUCTION, OR DISTRIBUTION IS PROHIBITED UNLESS AUTHORIZED IN WRITING BY THE ARCHITECT.

DRAWN	JAV
CONTRACT DATE	10/12/22
SCALE	AS SHOWN
JOB NO.	2181.PRJ
SHEET TITLE: BLDG ELEVATIONS	
SHEET NUMBER: A-3.1.1A	